

Pop Shelter

Notice D'assemblage

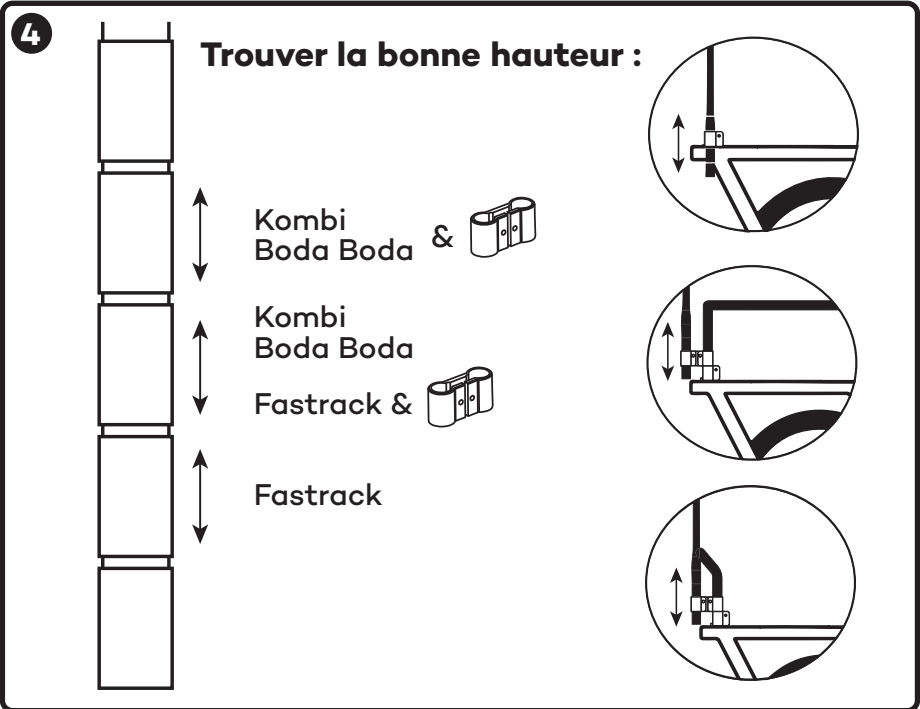

Regardez la video
explicative !

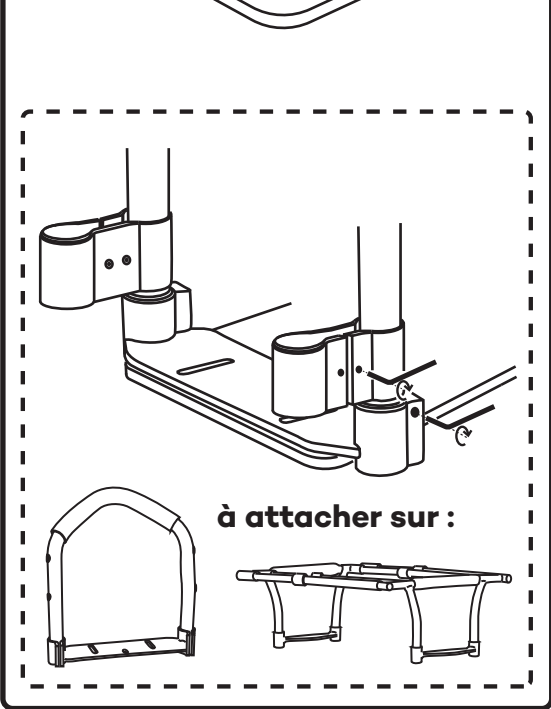
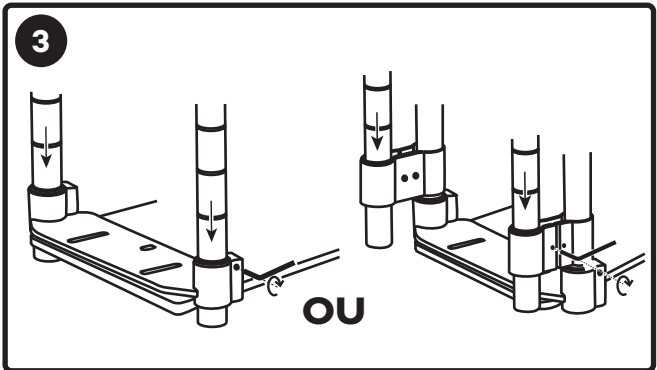
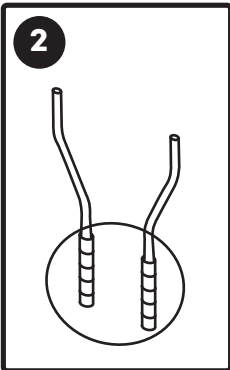
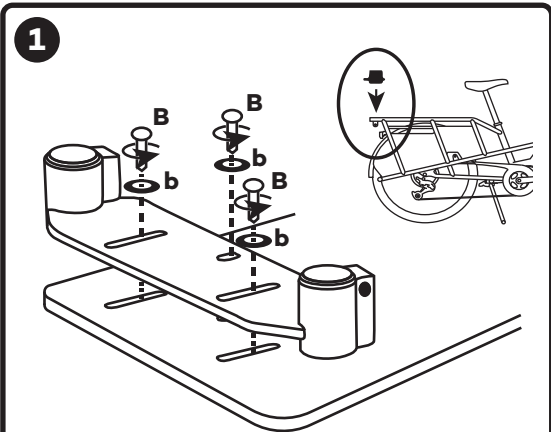
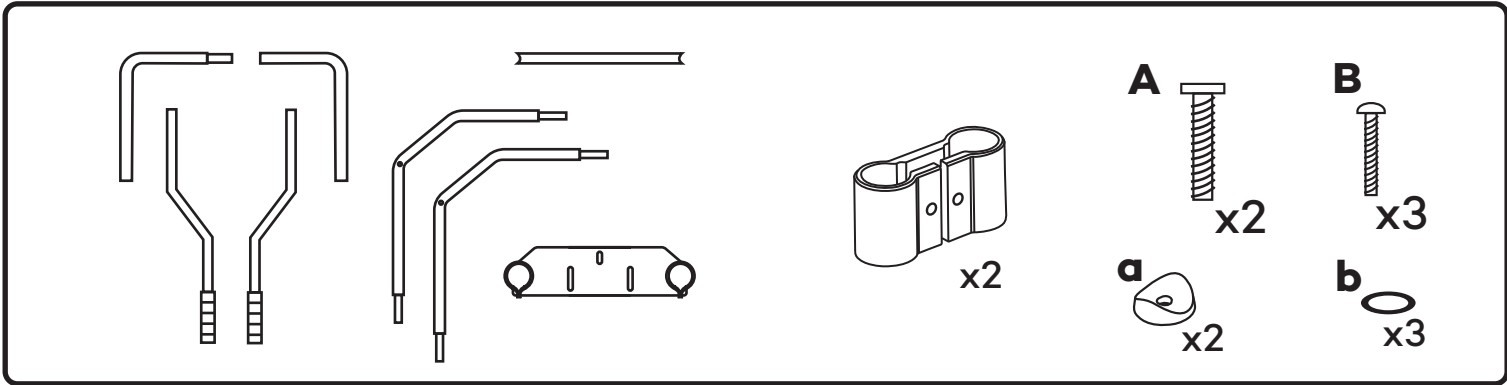

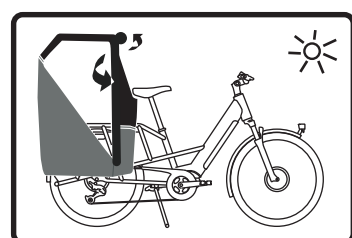
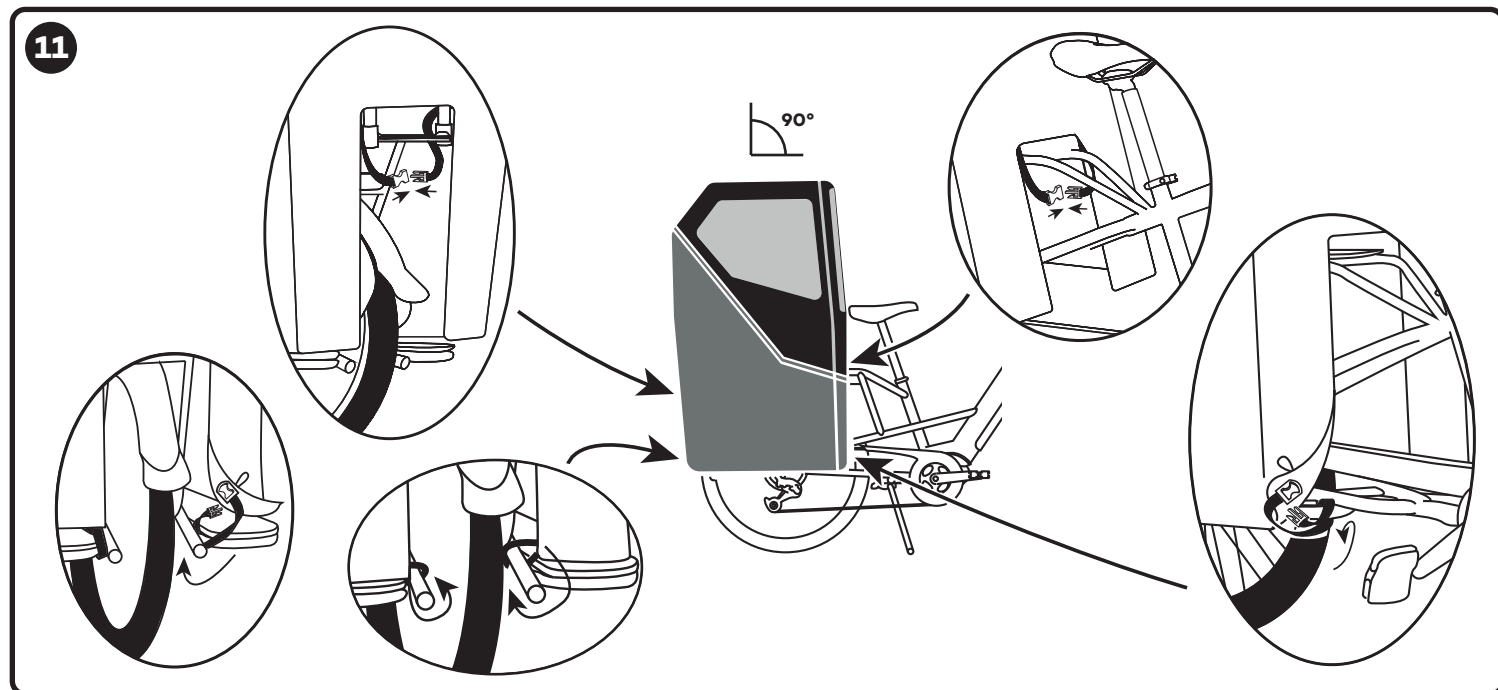
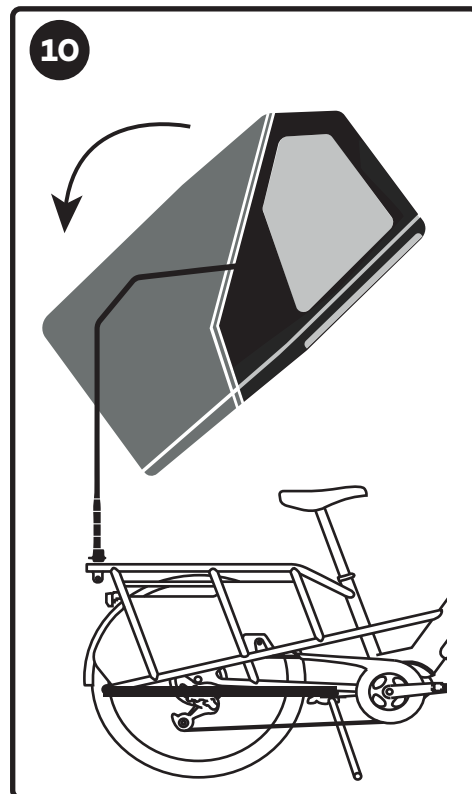
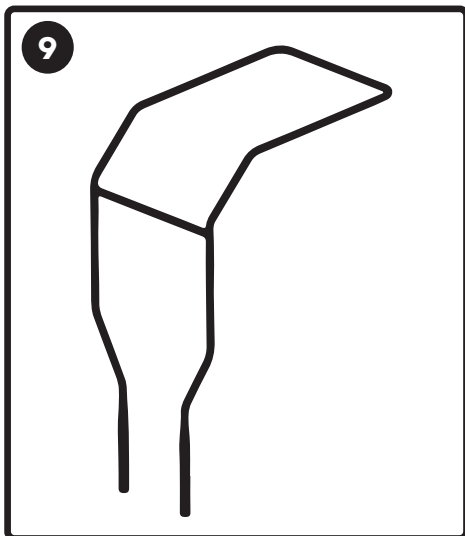
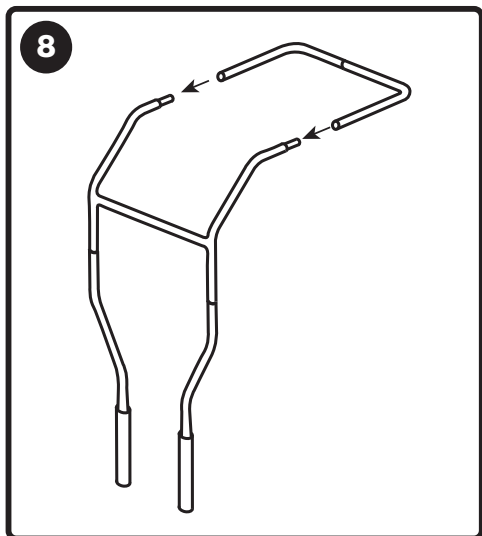
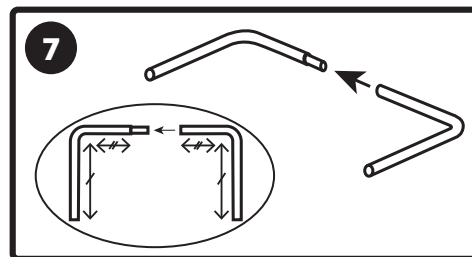
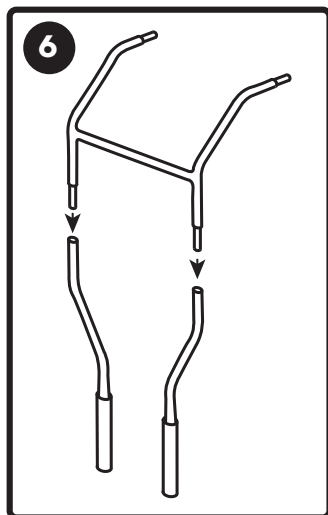
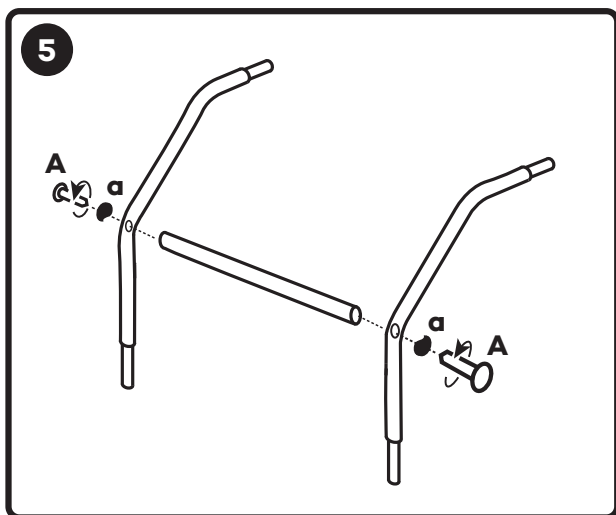

ATTENTION

Soyez vigilant à la résistance au vent du produit en roulant, le vent de travers peut causer des changements de direction dangereux. Assurez-vous également d'avoir les roues dégagées avant de rouler.

ATTENTION

- Ne pas dépasser un couple de serrage de **5N.m**.
- Ne pas serrer au delà du nécessaire pour bloquer le glissement du cadre.

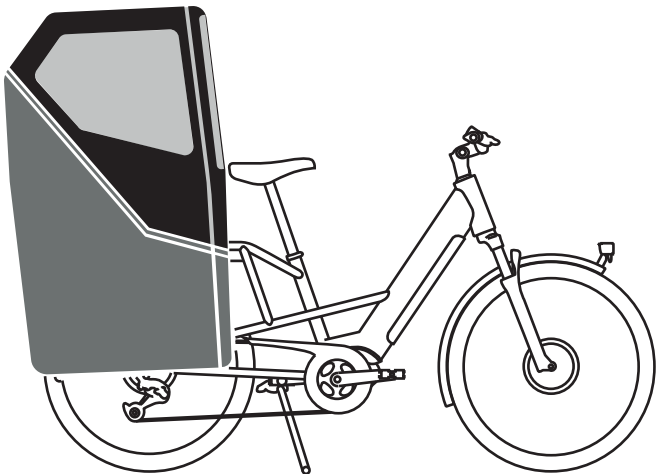

Pop Shelter Assembly Notice



Check the
explanatory video!

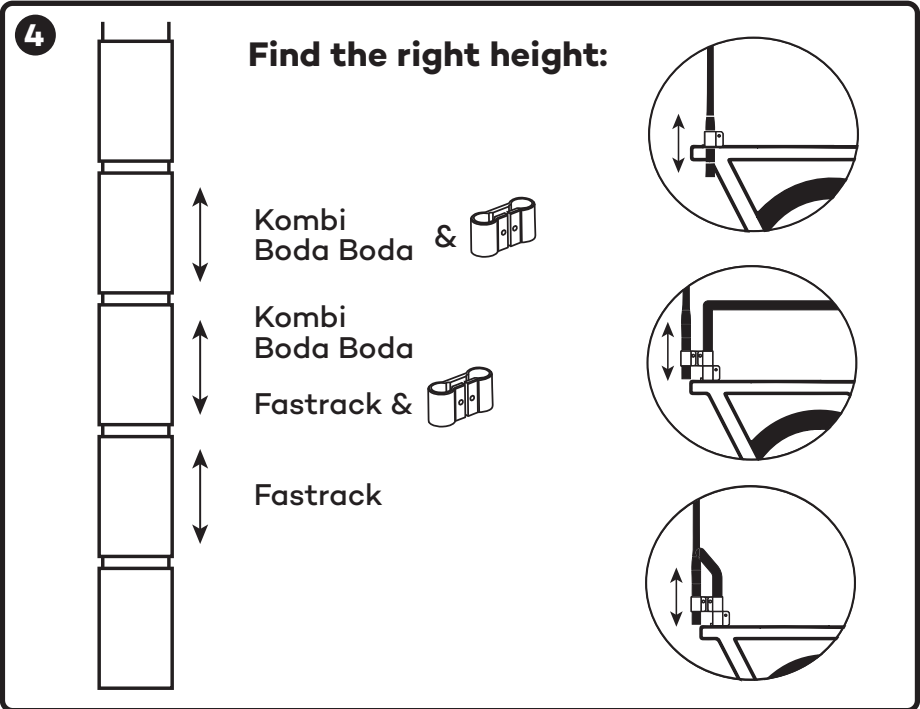
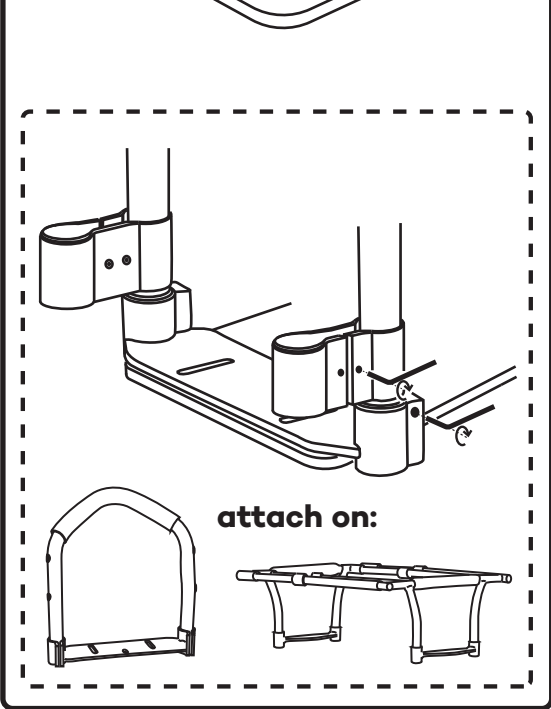
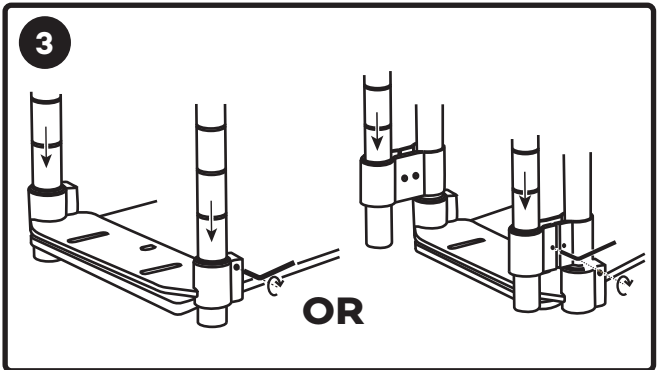
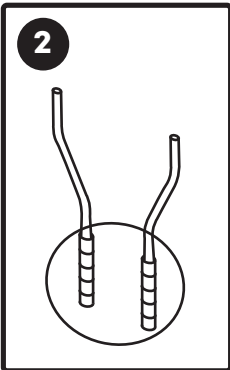
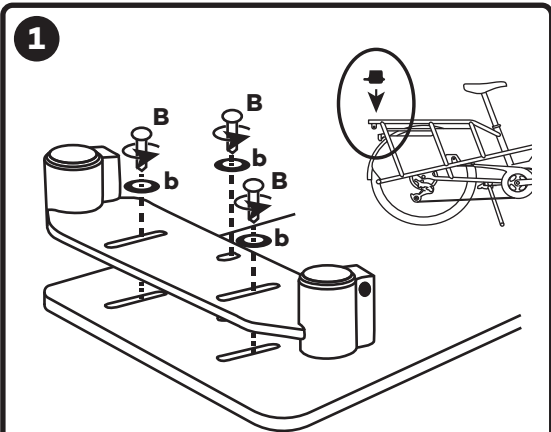
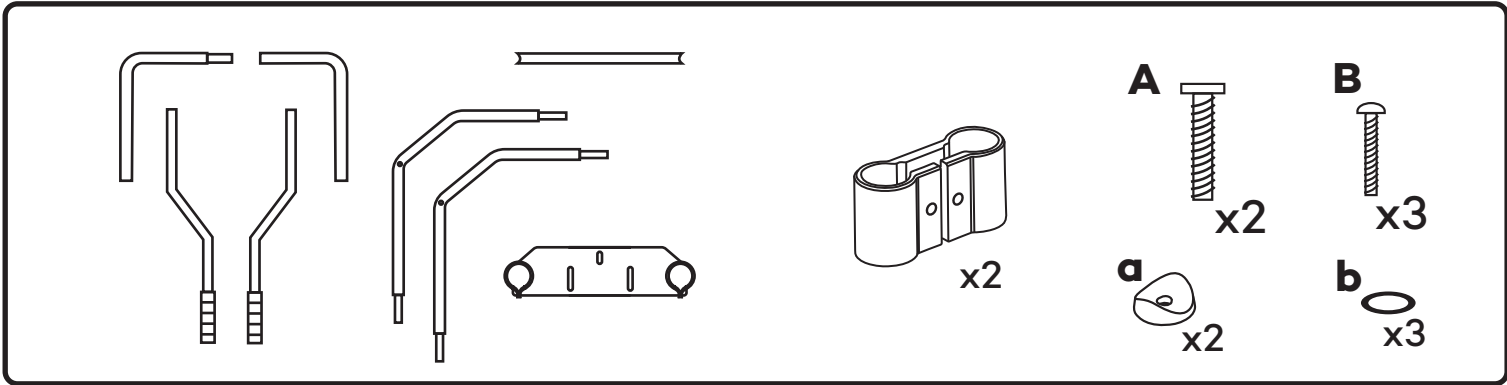

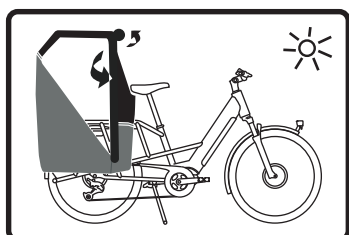
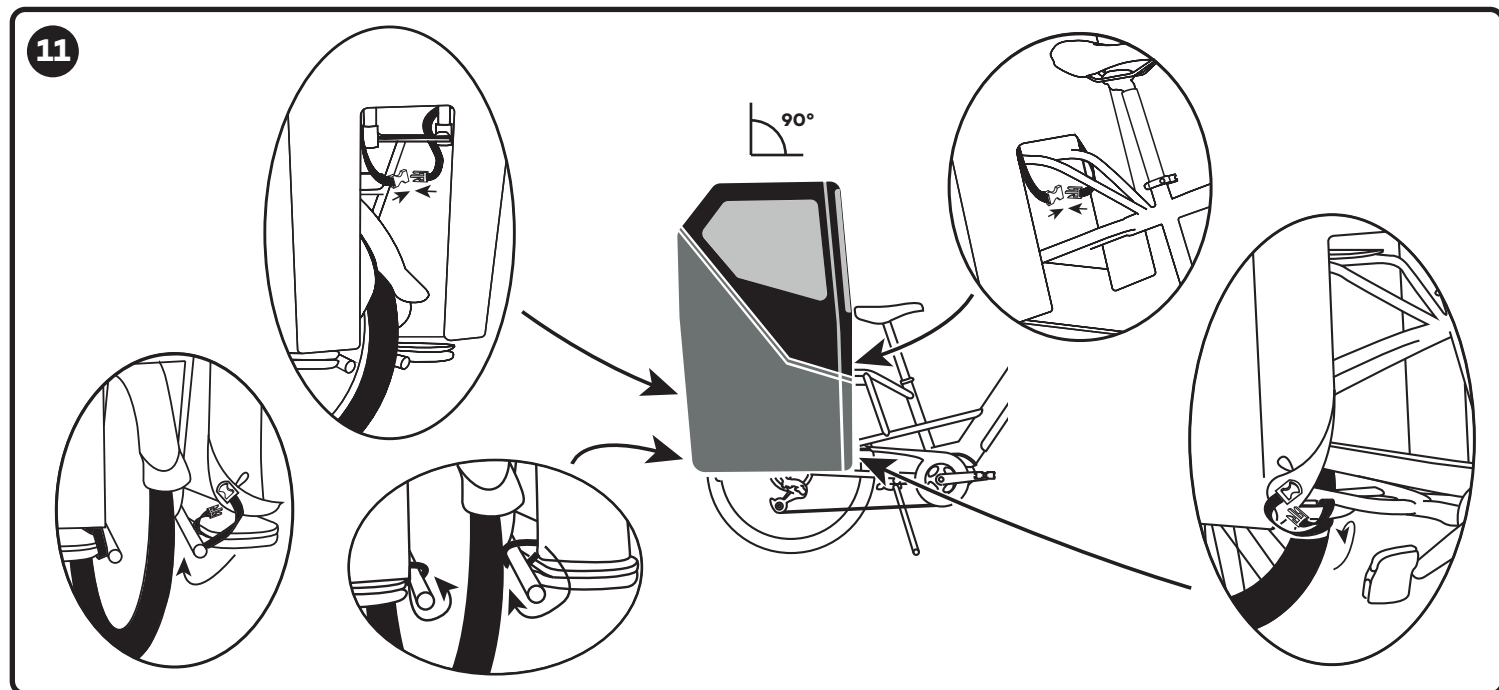
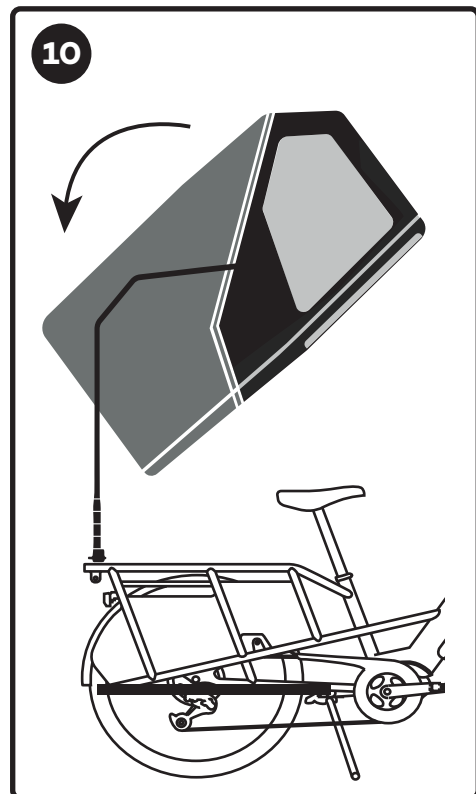
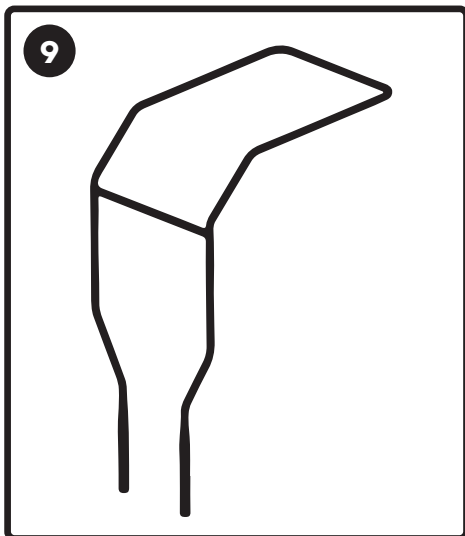
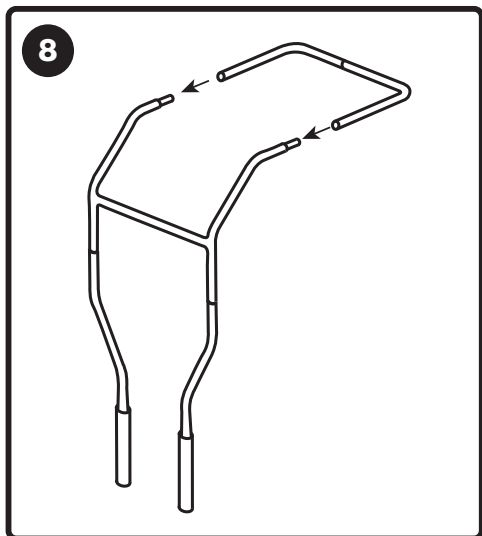
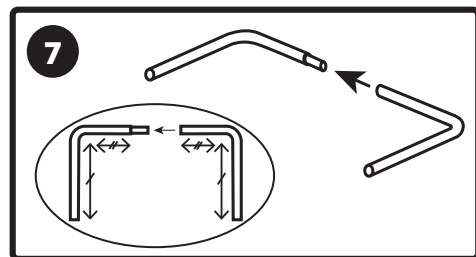
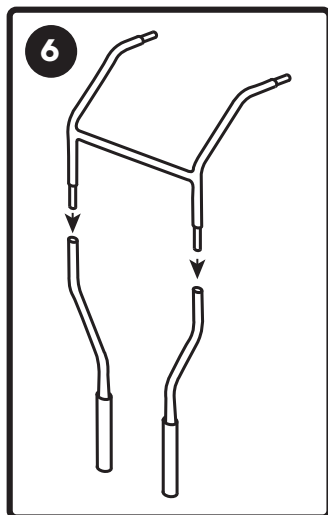
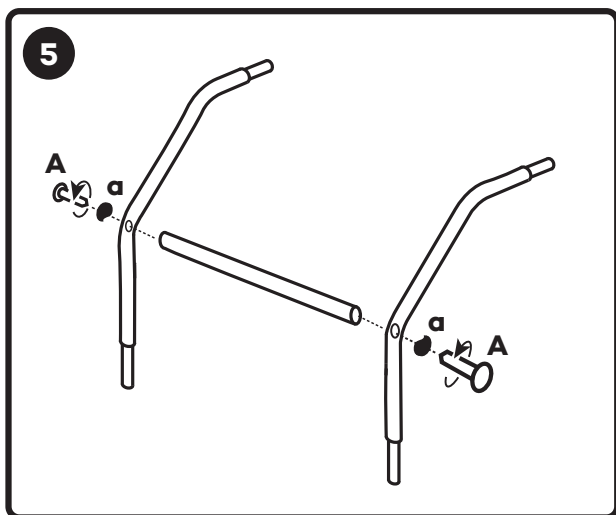

WARNING

Pay attention to the wind conditions while riding, crosswind can easily affect handling and changes riding direction.
Always check the wheel clearance before riding.

WARNING

- Do not exceed a tightening torque of **5N.m**.
- Do not tighten beyond what is necessary to block the sliding of the frame.