

# The Roots

Lever Actuated Kickstand

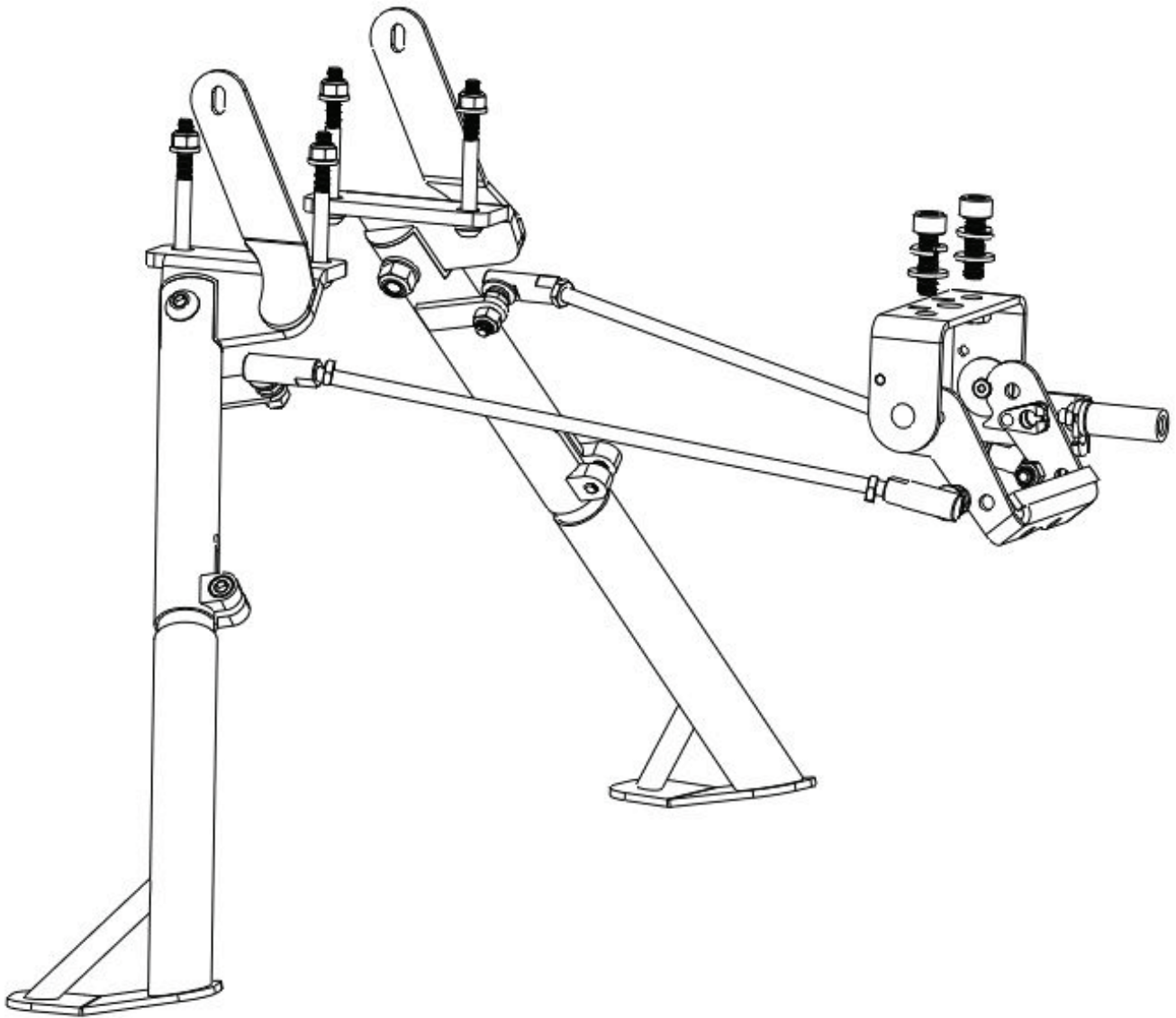

# THE ROOTS

## Lever Actuated Kickstand

### Kickstand Setup

1. Attach the the roots kickstand base plate to the bike frame.
2. Adjust the length of the leg actuating rod. Make sure the rod is the same length on both sides.
3. Attach the legs to the bike frame.
4. Adjust the leg length.

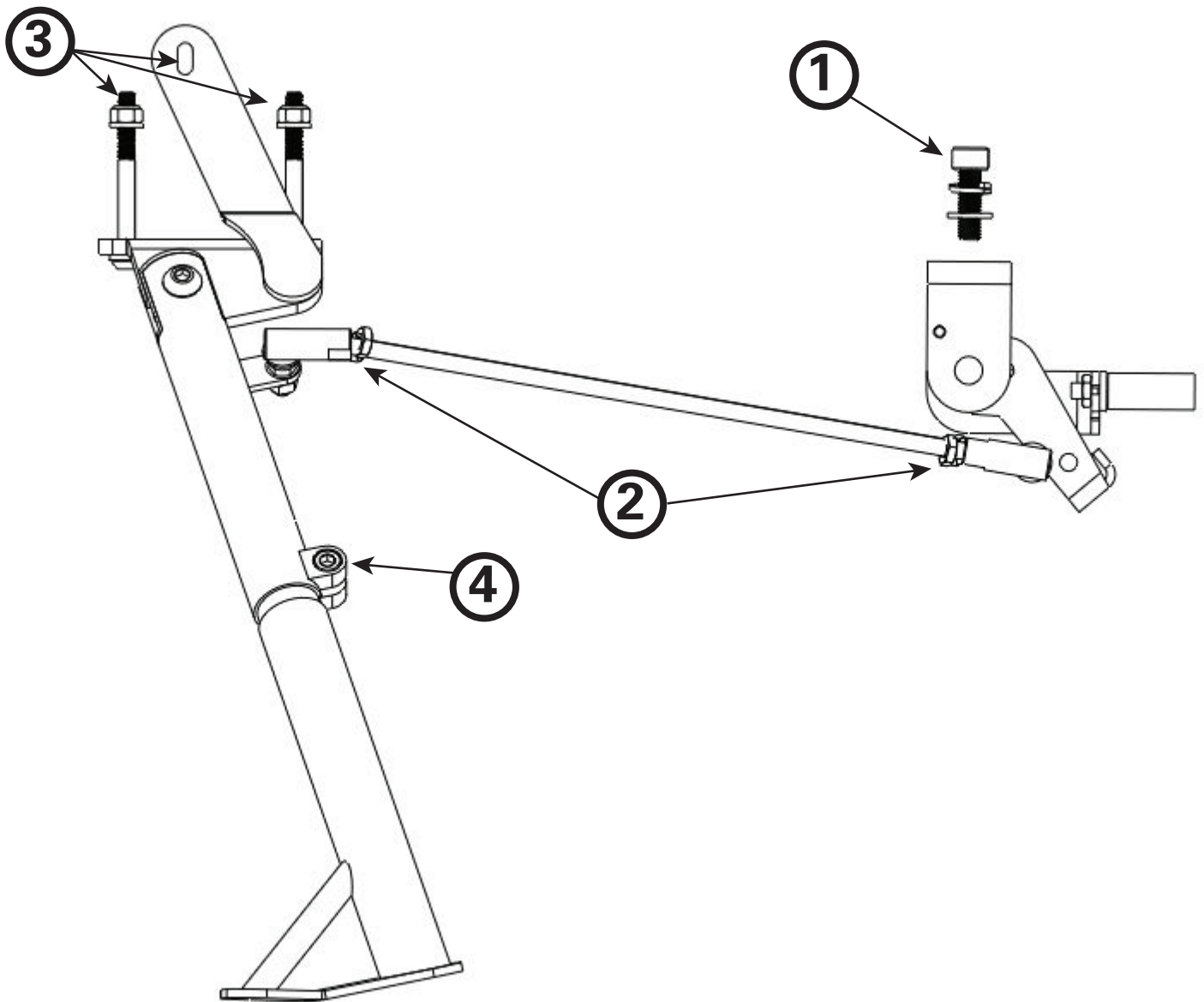

# THE ROOTS

## Lever Actuated Kickstand

### Lever Setup

1. Attach the the Lever to the bike frame.
2. Run the Cable from the kickstand through the Lever. The correct cable routing is shown with a dashed line.
3. Tighten the bolt to secure the cable in place.

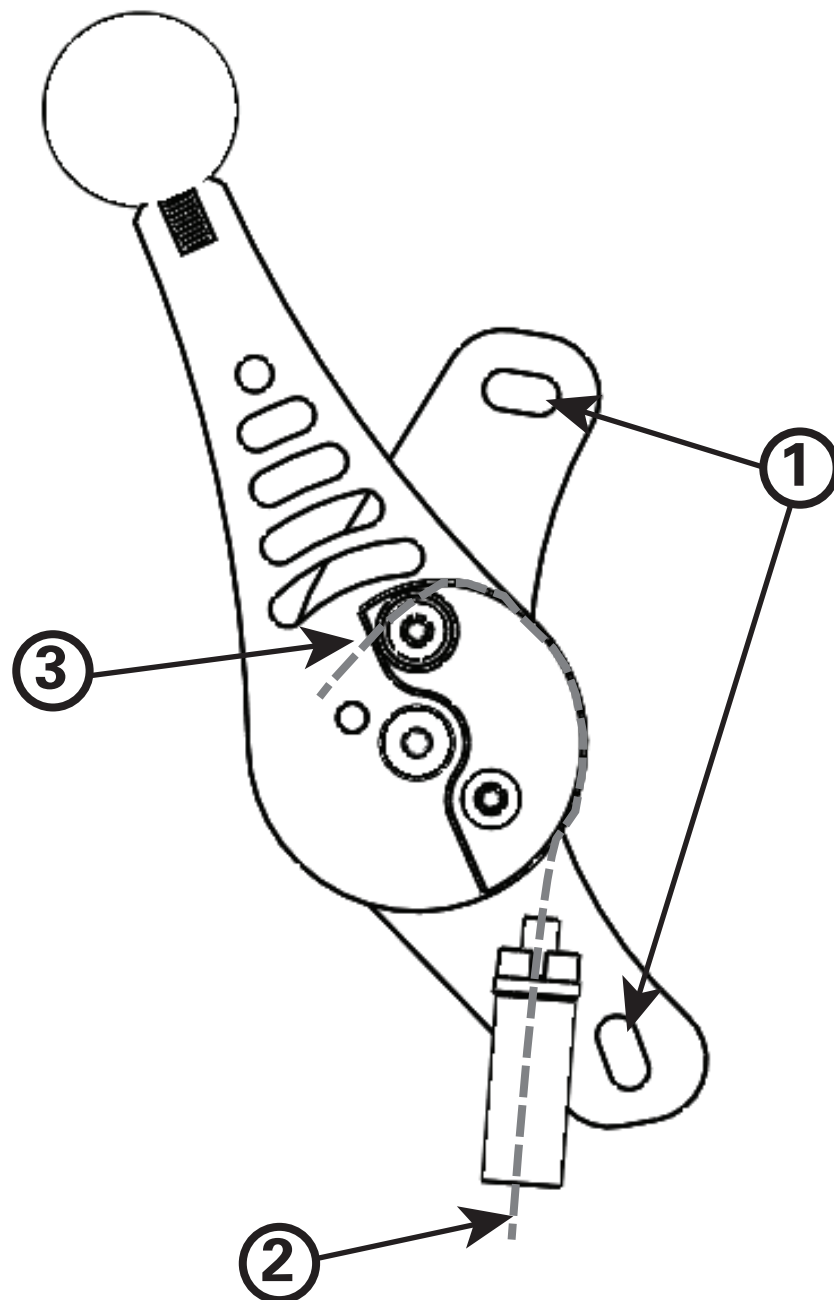

# THE ROOTS

Lever Actuated Kickstand



## Warnings and Safety Precautions

### *General warnings*

- **WARNING!** Failure to comply with these instructions may lead to serious injury or death.
- **WARNING!** Riding with an additional passenger may alter the riding characteristics of your bicycle, decrease stability, and increase braking distances.
- **WARNING!** Never leave a child unattended on the back of a bicycle.
- **WARNING!** Do not use with children who are too small or cannot balance/support their own weight independently.
- Do not allow passengers body, clothing, shoe laces or other personal items to come in contact with moving parts of the bicycle.
- Passenger should remain seated while bicycle is in motion.
- Ensure passenger is wearing an approved bicycle helmet.
- Never ride in inclement or hazardous situations.
- Ensure a rear reflector is installed and visible when a passenger is aboard.
- Never ride a bicycle at night without adequate lighting.
- Presence of an additional passenger may require alteration of the method used by the rider to mount or dismount the bicycle. Care must be taken whenever the rider gets on or off the bicycle.

### *Specific hardware and component warnings*

- **WARNING!** Overloading Kickstand may cause it to fail.
- **WARNING!** Regularly check to make sure the bolts have not loosened. Do not use if parts are cracked or damaged.

For questions or support please contact your local Yuba Bicycles dealer or email [info@yubabikes.com](mailto:info@yubabikes.com).